



7, The Carriage Works, Dogpole, Shrewsbury, SY1 1EZ

£1,150 Per Month



7, The Carriage Works, Dogpole, Shrewsbury, SY1 1EZ

£1,150 Per Month

VIRTUAL TOUR AVAILABLE - Commanding an elevated position within the historic town centre this two double bedroom second floor apartment benefits from fantastic views over the River Sever and beyond. Secure covered parking space.

Available: 22/08/25

Description

Comprising: Entrance hall, living room with excellent views over the River Severn, kitchen including white goods, master bedroom including en-suite bathroom, further double bedroom, shower room. Double glazing, gas central heating. Secure allocated parking. EPC: B



Unfurnished

Council Tax Band: D

Available: 22nd August 2025

EPC: B



Floor Plans

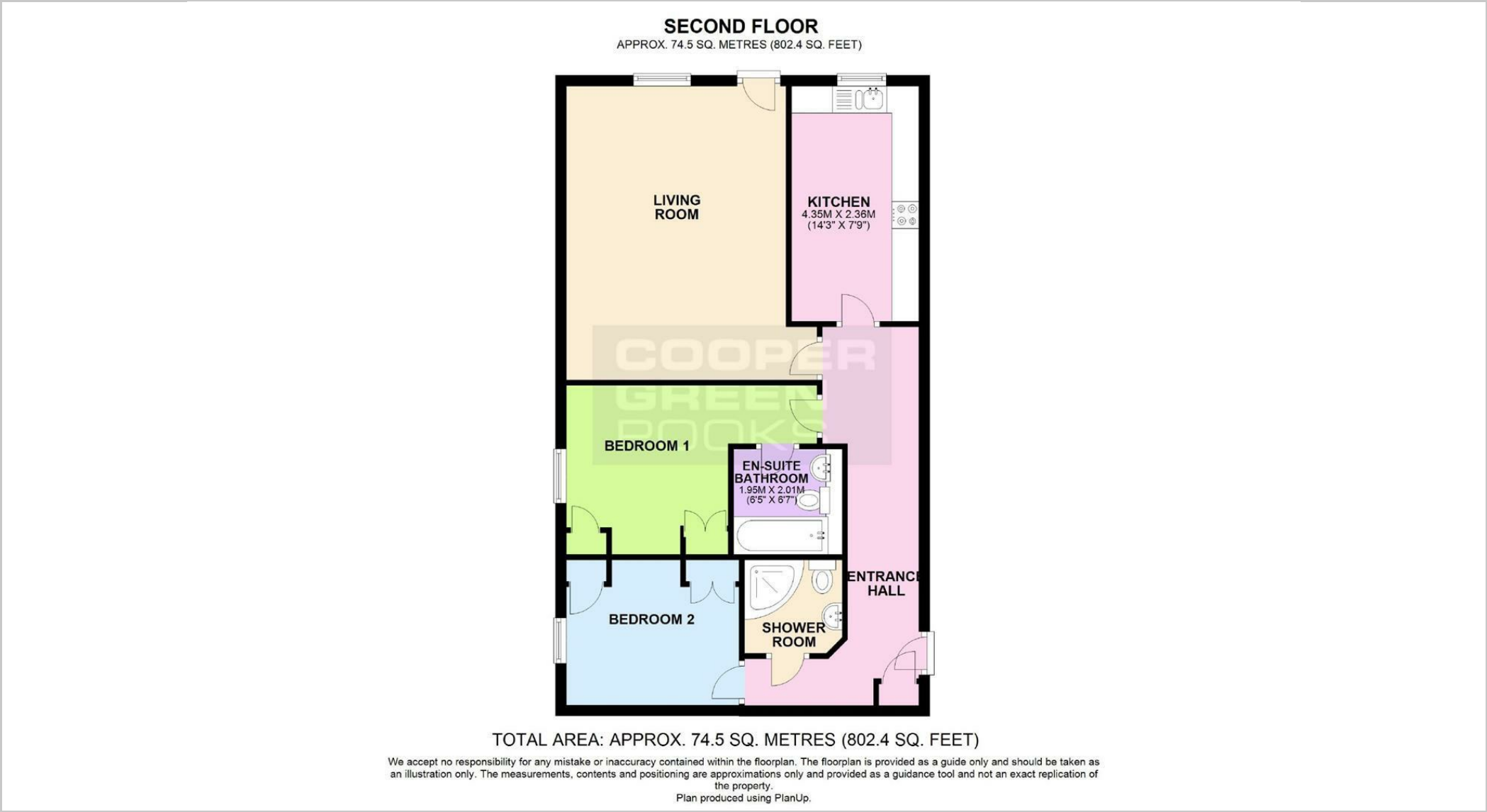

These particulars, whilst believed to be accurate are set out as a general outline only for guidance and do not constitute any part of an offer or contract. Intending purchasers should not rely on them as statements of representation of fact, but must satisfy themselves by inspection or otherwise as to their accuracy. No person in this firms employment has the authority to make or give any representation or warranty in respect of the property.